



## **INHALT**

Allgemeine Sicherheitshinweise	3
Bestimmungsgemäße Verwendung	3
Lieferumfang (Fig. 1)	4
Teileübersicht (Fig. 2)	5

### **Inbetriebnahme**

Stromversorgung der Wetterstation herstellen	6
Die HomGar™-App installieren	6
Wetterstation mit der App koppeln	6
Thermo-Hygro-Außensensor mit der Wetterstation/App koppeln	10
Wasser-Timer und Bodensensor mit der App koppeln	11
Wasser-Timer am Wasserhahn anbringen	12
Bodensensor mit dem Wasser-Timer koppeln und positionieren	13

### **Bedienung**

HomGar™-APP	14
Geräteseite Wetterstation	15
Bewässerung einstellen	16
Regenverzögerung	18
Wasserverbrauchkalibrierung	18
Automatische „Bewässerungsplan stoppen“-Funktion	18
Sprachdienst von Drittanbietern	19
Wetterstation	20
Wasser-Timer	22
Entsorgung	23
Konformitätserklärung	23

## GENERAL SAFETY INSTRUCTIONS

### **Danger of serious or fatal injury!**

Due to technical electromagnetic radiation, parts of this product may affect the functionality of medical implants. For example, cardiac pacemakers or hearing aids can trigger disturbances that can lead to serious or even fatal injuries. People with medical implants should consult their doctor and manufacturer before using the product.

### **Danger of suffocation!**

- Keep packaging materials (plastic bags, rubber bands, etc.) away from children!
- This product contains small parts that can be swallowed by children!

### **Attention!**

- Only use the automatic “Stop Irrigation Schedule” function based on soil sensor data under supervision to manually interrupt the water supply in the event of any malfunctions.

### **Property damage and malfunction warning**

- Do not disassemble the device! In the event of a defect, contact the service center in your country (noted on the warranty card).
- Use only the recommended batteries. Always replace weak or empty batteries with a new, complete set of batteries at full capacity. Do not use batteries from different brands or types or with different capacities. The manufacturer assumes no liability for voltage damage as a result of incorrectly inserted batteries!
- Remove batteries from the device if it is not in use for a long time or before cleaning it!
- Make sure that the vent on the weather station is not blocked to ensure smooth operation of the unit.
- Do not use the product near gas, heaters, microwave ovens and other positions that may cause interference.
- To operate smoothly and correctly, please place the weather station gateway on a stable plane for use.

## INTENDED USE

The BRESSER Smart Home irrigation system Smart Garden is used to control sprinklers and irrigation systems. It enables automatic irrigation, for which the time and duration are set via an app. The product is intended exclusively for outdoor irrigation and for private use.

## SCOPE OF DELIVERY (FIG. 1)



- A** thermo-hydro outdoor sensor (1x), **B** weather station (1x),  
**C** 1 zone water timer (1x) (in 7510100),  
**D** Soil sensor (1x),  
**E** 2-zone water timer (1x) (in 7510200)

Accessories may vary by model.

## FIG. 2

### ❶ Freezing point alarm

The icon flashes when the temperature is in the range 0°C–2.9°C (32°F–37.22°F), and will continue to display when the

## PARTS OVERVIEW (FIG. 2)

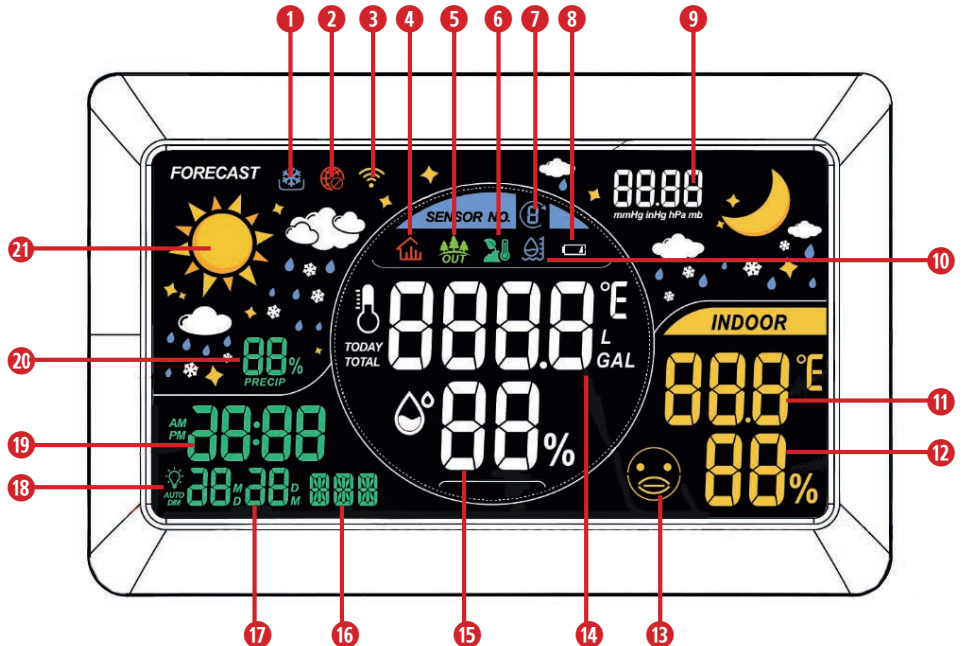

temperature is below 0°C (32°F).

- ❌ Failed to connect to server  
If this icon appears, please restart the device
- 📶 WiFi signal display
- 🏠 Indoor sensor display (optional accessory)
- 🌳 Outdoor sensor display
- 🌱 Soil sensor display
- 📶 Sensor channel display shows each channel is displayed every 5 seconds.
- 🔋 Low battery indicator of smart
- 📊 Barometric air pressure in mmHg, inHg or hPa/mb  
This is absolute air pressure.
- 📊 Flow meter display (optional accessory)
- 🌡️ Indoor temperature
- 💧 Indoor humidity
- 👤 Indoor Comfort Level Indicator
- 🌡️ Outside temperature
- 💧 Outdoor humidity
- 📅 Weekday abbreviation in 7 languages
- 📅 Date
- 💡 Smart backlight mode
- 🕒 Current time 12/24-hour format selectable
- 🌧️ Rain probability range: 0% to 99%
- 🌤️ Weather Forecast

**Base station**

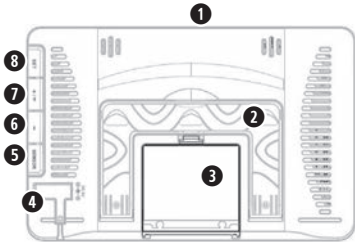

- 1 [ ]-touch button
- 2 Fold-out stand
- 3 Battery compartment
- 4 DC jack
- 5 Sensor button
- 6 [-] button
- 7 [+ / 📶] button
- 8 SET button

**Outdoor thermo-hygro sensor**

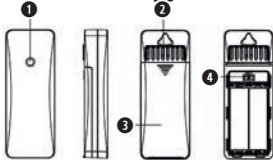

- 1 Indicator light
- 2 hanging hole
- 3 Battery compartment
- 4 CH channel switching

**1 zone water timer (7910101)**

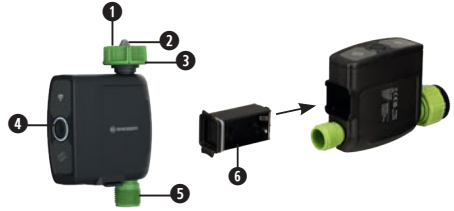

- 1 water inlet
- 2 inlet filter
- 3 union nut
- 4 Pairing/watering button with LED indicator
- 5 Water outlet
- 6 battery compartment

**2 zone water timer (7910102)**

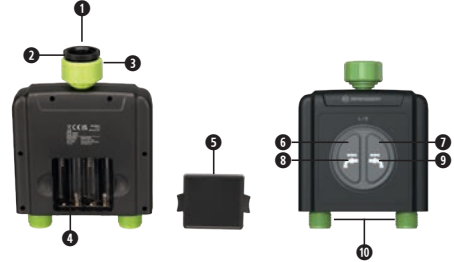

- 1 Water inlet
- 2 3/4" adapter
- 3 Union nut
- 4 Battery compartment
- 5 Battery compartment cover
- 6 Watering button L
- 7 Irrigation indicator R
- 8 Irrigation indicator L
- 9 Irrigation indicator R
- 10 Water outlets

**Soil sensor**

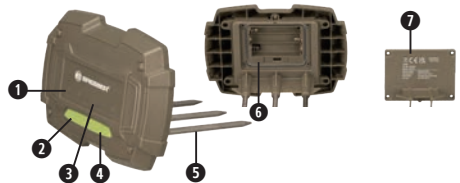

- 1 Operation
- 2 On/Off Button
- 3 Soil Moisture Indicator
- 4 Soil Moisture Test Button
- 5 Test Tips
- 6 Battery compartment
- 7 Battery compartment cover

## START-UP

### POWER THE WEATHER STATION

1. Plug the DC plug into the socket on the weather station.
2. Insert the mains plug into the power outlet. The device is powered on directly.
3. Wait until indoor temperature and humidity as well as air pressure are displayed on the weather station.

**NOTE:** Mains power is recommended for continuous operation. Alternatively, operation with batteries is also possible in order to maintain the time setting in the event of a power failure. Note that the display automatically switches to power-saving mode after 20 seconds when on battery power.

To supply power with batteries, follow these steps:

1. Remove the battery cover.
2. Place the batteries in the battery compartment. Observe the correct alignment of the battery terminals (+/-).
3. Replace the battery cover.
4. Wait until indoor temperature and humidity as well as air pressure are displayed on the weather station.

**NOTE:** When changing the type of power supply (mains power or batteries), the power supply is temporarily interrupted for technical reasons. All previous settings are lost. Exception: permanent battery operation.

### INSTALLING THE HOMGAR™-APP

The following requirements must be met to successfully connect to your WIFI:

- The weather station only connects to the Internet on the 2.4 GHz WiFi frequency. Most routers make the correct connection automatically. If this is not the case, you can usually make a manual adjustment on the router.
- Please connect the weather station to the mains via a power cable if you want to establish and maintain the WiFi connection.
- **iOS minimum requirement:** Mobile device with iOS 11.0 (or higher) + mobile/WiFi function.
- **Android minimum requirement:** Mobile device running Android OS 6.0 (or higher) + mobile/WiFi function.

#### Tips:

- Don't use public WiFi networks.
- If you need to change Wi-Fi network, press and hold **[+]** button and reconnect to HOMGAR™ APP, enter your new Wi-Fi network's login information.

HomGar™ app downloads:



or scan the QR code to download:



iOS



Android

1. Open the HomGar™ app on your mobile device.
2. Follow the instructions in the app to create an account. If you already have an account, sign in using your existing login details.

### PAIR THE WEATHER STATION WITH THE APP

**NOTE:** The weather station and your mobile device must be **less than 10 feet** apart during setup.

There are two ways to pair the weather station with the app:

#### Method 1: Intelligent Pairing mode



Open the app and from the home page, tap the “+” in the upper-right corner.



Under “Add Device”, tap “Weather Station Hub”.

Press and hold the **[+ / 📶]** button on the weather station until "SCAN" appears on the display. The weather station is now ready to pair.



In the app, check "All steps completed" and tap the "Next" button.



Enter your WiFi information with the correct password and tap the "Next" button.

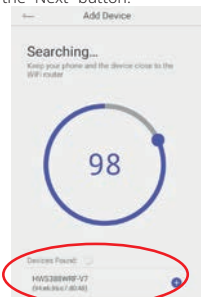

The search is started and the device model number of the weather station appears under "Found Devices". Tap the device model number.

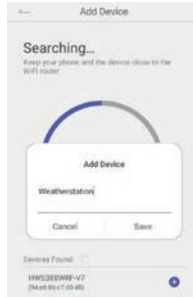

Enter a unique device name and tap "Save".



When the weather station has been successfully added, the corresponding device page appears in the app and "JOIN" appears on the weather station display for 5 seconds.

**NOTE:** If the network doesn't pair successfully within 120 seconds, try method 2.

## Method 2: AP pairing mode



Open the app and from the home page, tap the “+” in the upper-right corner.

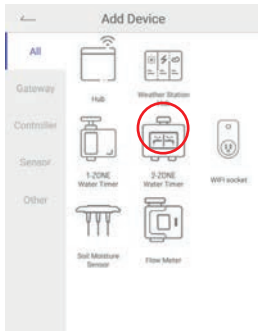

Under “Add Device”, tap “Weather Station Hub”.

Press and hold the **[+ / Wi-Fi]** button on the weather station until “SCAN” appears on the display. Press and hold the **[+ / Wi-Fi]** button on the weather station again until “SCAN AP” appears on the display. The weather station is now ready to pair.

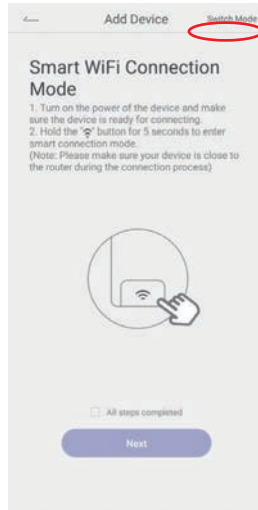

In the app, tap “Switch Mode” to switch to AP connection mode.

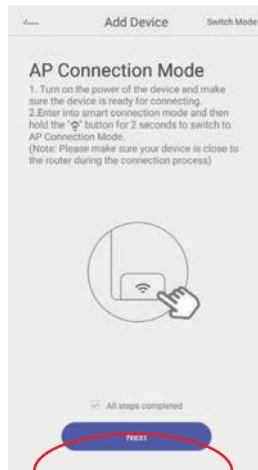

In the app, check “All steps complete” and then tap the “Next” button.





Tap the "Connect" button and connect your mobile device to the hotspot shown (HomGar\_xxxx). Return to the app and tap the "Next" button.



When the weather station has been successfully added, the corresponding device page appears in the app and "JOIN" appears on the weather station display for 5 seconds.

**NOTE:** If pairing mode was successful but the weather station display shows the globe icon, restart the weather station (i.e. turn it on again) to get it working normally again.



The search starts and the weather station device model number appears in the "Device Name" pop-up window. If necessary, enter a unique device name and tap "Save".

## PAIR THE THERMO-HYGRU OUTDOOR SENSOR WITH THE WEATHER STATION/APP



Set the desired channel on the sensor via CH channel switching **1** for the sensor. As default, Channel 1 is the outdoor sensor.

Place the batteries in the battery compartment **2**. Observe the correct alignment of the battery terminals (+/-).

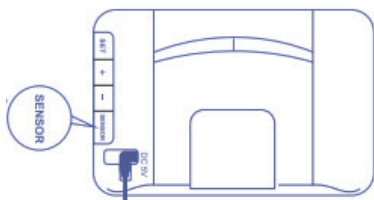

On the weather station, hold down the **[SENSOR]** button to activate pairing mode. The outdoor sensor readings area on the display starts to flash.

**NOTE:** During the pairing process, keep the sensor as close as possible to the weather station.

When the sensor has been detected, the measured values appear on the weather station display. In the app, the thermo-hygro sensor automatically appears on the home page when it is paired with the weather station.

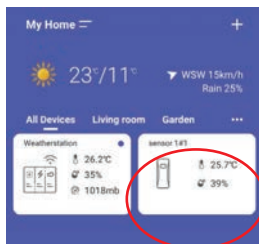

Install the thermo-hygro sensor with the hanging hole in your chosen location. Keep the following criteria in mind:

- The outdoor sensor must not be exposed to direct rain or sunlight, nor placed near a heat source.
- Ensure good ventilation of the sensor and leave a certain distance between the sensor and the wall.
- Place the sensor vertically with the hanging hole at a height of about 1.2 to 2.5 meters.
- Avoid thick walls between the sensor and the weather station, as well as strong sources of interference that use the same 433 GHz signal frequency, such as TVs, microwaves, computers, etc.
- If the weather station breaks the connection, the sensor is likely too far away. Please move it closer to the sensor. Radio signal transmission range: 100 m outdoor (The sensor is the unit that is connected to the weather station and transmits the signal to the weather station)
- The sensor must be installed vertically.

## PAIR THE WATER TIMER AND SOIL SENSOR WITH THE APP

**NOTE:** The water timer and soil sensor can only be paired with the weather station as sub-devices via the HomGar™ app. Pair the sub-devices with the app one by one. Proceed as follows:

Insert the batteries into the sub-device that you want to pair with the weather station. Observe the correct alignment of the battery terminals (+/-).



Open the app and tap the weather station field on the home page.

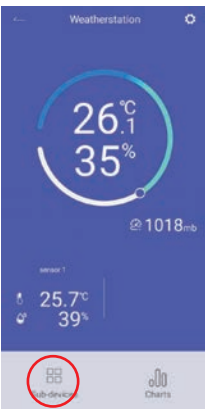

On the device page, tap "Sub-Devices".

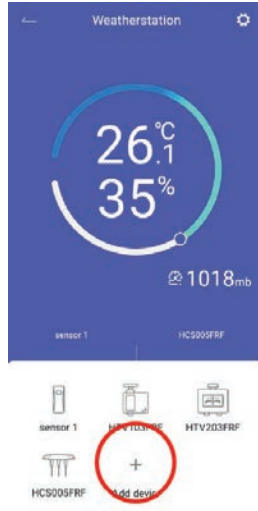

In the pop-up window, tap "+ Add device"

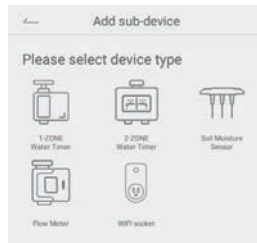

Tap the icon for the sub-device that you want to add:

- "1-Zone Watering Timer"
- "2-Zone Watering Timer"
- Soil sensor: "Soil moisture sensor"



Hold the sub device as close to the weather station as possible and tap the "Next" button.



Press and hold the Pairing/Watering button on the water timer or the ON/OFF button on the soil sensor until the LED on the sub-device to be paired flashes.

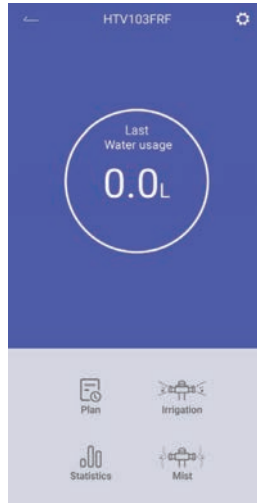

If the pairing was successful, the device page for the sub-device appears in the app.

### ATTACH WATER TIMER TO FAUCET

**ATTENTION:** To prevent water from entering the battery compartment, mount the water timer only vertically and with the union nut facing upwards.

To attach the water timer to a faucet with a 33,3 mm thread (1" thread):

1. Unscrew the black adapter from the union nut.
2. Screw the water timer to the faucet thread by turning the union nut.

To attach the water timer to a 26.5 mm (3/4" thread) tap:

1. Unscrew the black adapter from the union nut.
2. Screw the black adapter to the faucet thread.
3. Screw the water timer to the black adapter by turning the union nut.

## PAIR AND POSITION SOIL SENSOR WITH WATER TIMER

You can pair the soil sensor with your water timer via the HomGar™ app.



Open the app's home page and tap the corresponding field of the water timer that you want to pair with the soil sensor.

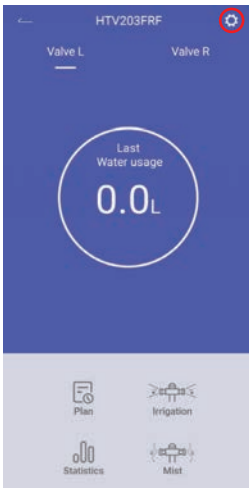

On the device page, tap the settings icon in the top right corner.

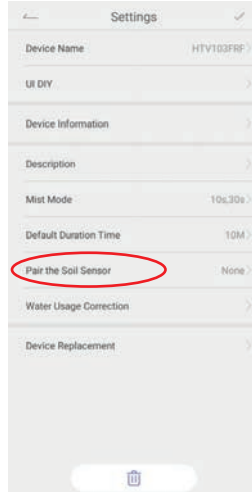

Tap "Pair the Soil Sensor".

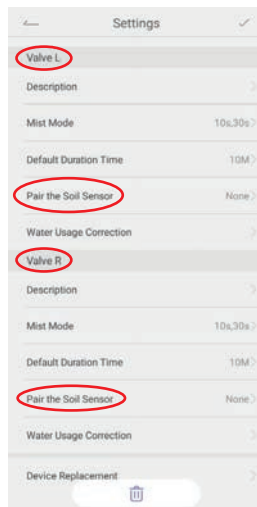

For the 2-zone water timer, make sure that you select the correct connection:

Valve L: left water outlet  
Valve R: right water outlet

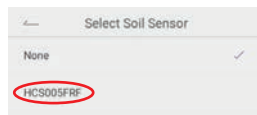

Select the floor sensor by tapping on the device name

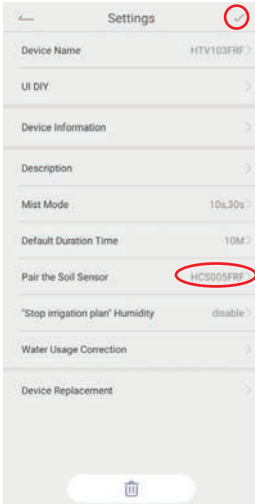

The device name of the soil sensor appears under Settings next to “Pair the soil sensor.”

Tap the check mark in the upper right corner to save the setting.

Position the soil sensor as follows:

- Remove the black plastic protectors from the soil sensor after pairing and before use.
- Make sure the soil sensor is no more than 30 meters away from the water timer.
- If the soil is very compacted, it is recommended to soften the soil by adding water before insertion.
- Push the soil sensor probe tips far enough into the ground so that they are completely buried in the ground.
- Make sure that the water around the floor sensor can drain well.

**ATTENTION:** Be careful not to drive the lawn mower over the soil sensor to prevent damage to property.

## OPERATION

### HOMGAR™ APP

#### Overview



#### 1 Home management

Here you can create your own home pages for different locations and switch between the different home pages.

#### 2 Add device

Add the HomGar series devices to start setup your smart home system.

#### 3 Local weather

Shows you the local weather based on the location information set in Home Settings. The data is updated every hour.

Tap on the local weather to get to a detailed overview page.

#### 4 Device Overview (All Devices)

All added devices will display here . Tap the box for each device to go to its device page.

#### 5 Space system management

Switch between the different rooms and areas by tapping on their names to see the assigned devices.

## 6 Home settings

Here you can:

- change your home name
- Add/delete rooms and areas for room system management and assign devices to rooms and areas
- Set location (base for local weather in the app)
- Set time zone
- Invite members
- Set units

## 7 Home page

Shows all important information at a glance.

## 8 Plan overview page



Overview of all irrigation plans. Tap the appropriate plan to edit it.

## 9 Events page

Here you can find an event log of past activities.

## 10 Profile page

This will take you to

- Home Management
- Quick guide and FAQ
- Information about setting up third-party voice services (Amazon Alexa, Google Assistant)
- Setting language, notifications and color theme (background color, etc.)
- Information about the app

## WEATHER STATION DEVICE PAGE

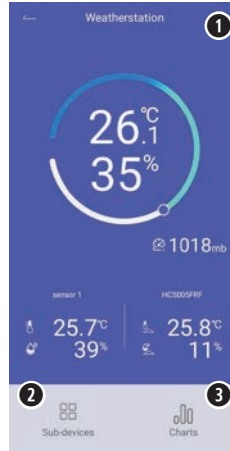

## 1 Settings

Here you can:

- Change device name
- Change the background image and font color under "UI DIY"
- View device information
- Change weather station display language
- Adjust auto backlight
- Edit sensor number setting:  
Adjust channel 1/2/3 sensor, adjust channel 4-9 sorting. Click "≡", "●", and "⊕" to resort and exit. To re-add a device that has been removed from display, click "Re-add".
- Adjust receive channel ("receive channel"): The default channel is channel 1. If there are more gateways in an area, for example a neighbor uses the same model's gateway, you can set different receiving channels to reduce the probability of communication conflicts.
- To replace the device: If the device is faulty, you can use the "Device Replacement" function to replace the defective device with the new one. Please pair the new device first, then select "Device Replacement" to replace the device as prompted by the App.

To save your settings, tap the check mark in the upper-right corner.

## 2 Sub-devices

Add new sub-devices here by tapping "+ Add device".

To go directly to the associated device page of an already paired sub-device, tap the corresponding device name.

## ① Tables

Curve charts of the last 24 hours/10 days/More.



Tap the device name in the upper-right corner to select the desired item and/or switch devices.

## ADJUST WATERING

On the home page, tap the corresponding water timer box to open the corresponding device page for irrigation settings.

### Device side

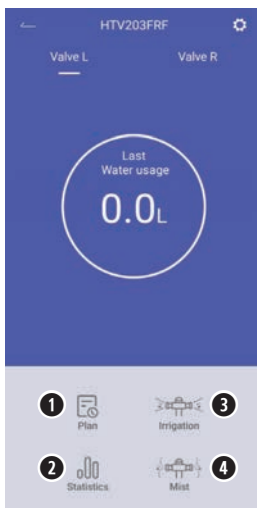

## ① Plan page

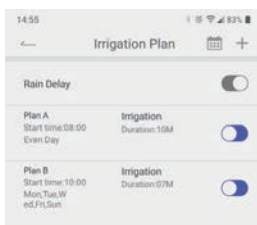

On the device page, tap "Plan" to open the plan page.  
To adjust an existing irrigation schedule, tap the name (e.g. "Plan A").

To turn off the irrigation schedule, tap the corresponding irrigation schedule slider.

To create a new irrigation schedule, tap the "+" in the upper right corner. This takes you to the plan settings.

## Plan settings

You can make the following settings here:

- Irrigation mode
- Start time
- Control mode: Set either the duration of irrigation or water consumption with maximum working time.
- Redo: Choose from "every day," "odd days," "even days," and "adjust" (based on the day of the week).

Save your settings by tapping the check mark in the upper-right corner.

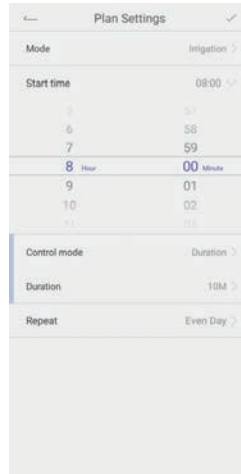



## Statistics

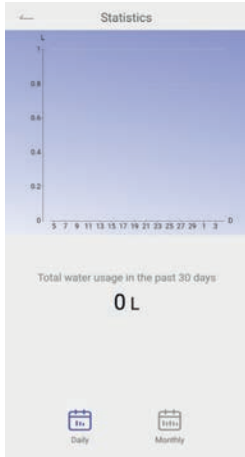

Tap Statistics for daily and monthly water usage information.

## Irrigation

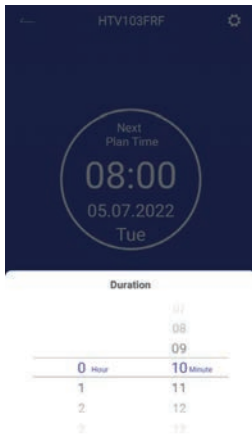

Tap Irrigation to manually start the water supply in Irrigation mode.

To do this, set the duration of irrigation in the pop-up window and tap "Confirm".

Irrigation starts immediately and the app shows you the remaining duration.

To stop watering before the set duration has elapsed, tap Irrigation again, then tap "Confirm".

## Fog

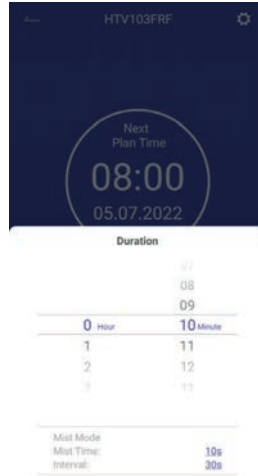

Tap "Mist" to manually start the water supply in "Mist" mode.

To do this, set the duration of irrigation in the pop-up window and tap "Confirm".

Irrigation starts immediately and the app shows you the remaining duration.

To stop watering before the set duration has elapsed, tap "Fog" again, then tap "Confirm".

## RAIN DELAY

Rain delay allows you to pause irrigation schedules for 24 hours. You can make this setting in two places in the app:

### Plan overview page



On the plan overview page, you will find an overview of all irrigation plans. Tap the slider of the corresponding water timer to activate the "rain delay." This means that all irrigation plans for the water timer connection are paused for 24 hours.

Tap "... " at the top right to turn rain delay on or off for all irrigation plans.

### Sub-device plan page



On the plan page of the sub-device, you will find all irrigation plans of the corresponding water timer connection. Tap the slider to turn on "Rain Delay". This means that all irrigation plans for the water timer connection are paused for 24 hours.

## WATER CONSUMPTION CALIBRATION

The standard flow accuracy of the water timer is:  $\pm 8\%$ .

To increase flow accuracy, you can measure actual water consumption and compare it with the flow data displayed on the app. On this basis, you can set a corresponding correction value with the "Water consumption calibration". Proceed as follows:

On the device page of the corresponding water timer, tap the settings icon.

On the "Settings" page, tap "Water Usage Calibration". Select a correction value from -20 to 20% and tap the check mark in the upper right corner to save.

## AUTOMATIC "STOP WATERING SCHEDULE" FUNCTION

**ATTENTION:** Use automatic "stop irrigation schedule" function based on soil sensor data only under supervision to manually interrupt the water supply in the event of any malfunctions.

With the automatic "Stop Watering Schedule" function, you can set a soil moisture value that should not be exceeded. If this value is measured by the soil sensor, irrigation stops automatically, even if the irrigation schedule provides for a longer irrigation period.

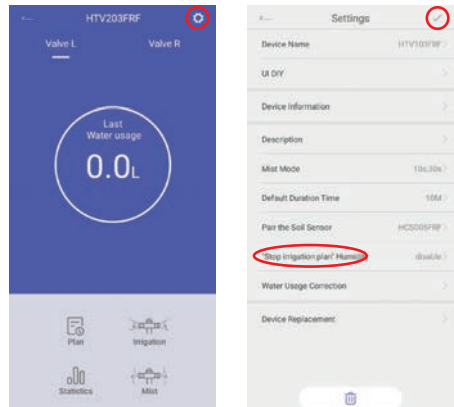



On the device page of the corresponding water timer, tap the settings icon.

If the soil sensor is paired with the water timer, you can tap the "Stop Watering Schedule" function here.

Adjust the desired soil moisture value by moving the slider (for example, 60% equals 60% soil moisture).

Tap the check mark in the upper right corner to save the setting.

You will automatically be returned to the settings page. Again, tap the check mark in the upper right corner to save all settings.

### THIRD-PARTY VOICE SERVICE

**NOTE:** Please read the detailed description of the third-party voice service, which can be accessed via the profile page in the HomGar™ app.

#### Amazon Alexa

1. Open the Alexa App on your phone, log in successfully and select "Skills&Games" on the MORE page.
2. Search for "Homgar Smart" and select it.
3. Click "ENABLE TO USE" to enable Skill.
4. After you have entered the password of your HomGar™ app account, click Sign In to integrate your HomGar app account. You can now activate the skill and travel to your smart home.

**NOTE:** Note that you must use the exact device name for your voice command.

#### Examples:

Alexa, [device name] on.  
Alexa, turn off the [device name].

Generic phrases such as "Alexa, turn off the water timer" is not recognized if the term "water timer" is not the exact device name.

#### Google Assistant

1. Open the Google Home app on your phone, sign in, click the "+" icon in the upper left corner, then click the "Set up device" option and select the "Works with Google" option.
2. Enter your account password through Homgar Smart to bundle your app account and give it access to your Google Account. You are ready to start your smart home journey.

**NOTE:** Note that you must use the exact device name for your voice command.

#### Examples:



Hey Google, open [device name].  
Hey Google, close [device name].  
Hey Google, turn on [device name].  
Hey Google, turn off [device name].

Generic phrases such as "Hey Google, turn off water timer" is not recognized if the term "water timer" is not the exact device name.

## WEATHER STATION

**NOTE:** To get accurate measurements, please keep the weather station away from high heat or cold and make sure the other sensors are also protected from direct sunlight, rain or heat.

### Buttons Introduction

Buttons	Functions
[SET]	<b>Normal Mode:</b> <ul style="list-style-type: none"> <li>Press and hold the button to enter manual adjustment mode.</li> </ul>
[+/ 	<b>Normal Mode:</b> <ul style="list-style-type: none"> <li>Press and hold the button to activate smart pairing mode</li> <li>Press and hold again to enter AP pairing mode.</li> </ul> <b>Manual Setting Mode:</b> <ul style="list-style-type: none"> <li>Press to increase value</li> <li>Press and hold the button to increase the value continuously.</li> </ul>
[-]	<b>Manual Setting Mode:</b> <ul style="list-style-type: none"> <li>Press to decrease value</li> <li>Hold the button to decrease the value continuously.</li> </ul>
[SENSOR]	<b>Normal Mode:</b> <ul style="list-style-type: none"> <li>Press to switch channel,</li> <li>Press and hold the button to enter pairing mode and reconnect to the sensor.</li> </ul>
	<b>Normal Mode:</b> <ul style="list-style-type: none"> <li>Press to enter the backlight brightness function.</li> <li>Press and hold the button to turn the automatic backlight on and off.</li> </ul> <b>Manual Setting Mode:</b> <ul style="list-style-type: none"> <li>Press to exit.</li> </ul>

### Indoor Comfort Level Indicator



DRY: Humidity  $\leq 40\%$



COMFORT:  $40\% \leq \text{humidity} \leq 70\%$   
 $20^\circ\text{C} (68^\circ\text{F}) \leq \text{temperature} \leq 28^\circ\text{C} (82.4^\circ\text{F})$



WET: Humidity  $\geq 70\%$

The comfort level indicator does not appear on the LCD when:

humidity  $\leq 40\%$ , humidity  $\leq 70\%$ ,  
 Temperature  $> 28^\circ\text{C} (82.4^\circ\text{F})$  or temperature  $< 20^\circ\text{C} (68^\circ\text{F})$

## weather forecast

After setting the location information in the app, weather data is automatically output from the network.



### NOTES:

- THIS IS NOT THE CURRENT WEATHER.
- Please note that this forecast is not comparable to professional satellite-based weather services and high-performance computers.



### Manual settings on the weather station

- In normal mode, press and hold the **[SET]** button on the weather station to enter setting mode.
- Press the **[SET]** button to skip or continue to the next step.
- Press the **[+]**/ button or the **[-]** button to set the value.

The setting order is:

Day of the week language → Unit absolute air pressure → °C/°F → Year → DM/MM display format → Month → Date → 12/24h time format → Hour → Minute → Leave.

### Backlight Function

- If the device is running on batteries, press the  button to turn on the backlight for 20 seconds.
- For continuous backlight, please use an AC adapter. Press the  button to switch brightness between 100%, 50%, 30%, 10% and OFF.
- Press and hold the  button to turn the automatic backlight on and off.
- 

### Low Battery Alarm

If the battery indicator  appears next to the corresponding sensor, please insert new batteries into the sensor.

## WATER TIMER:

Both the 1-zone water timer and the 2-zone water timer allow you to control the water supply manually without an app.

### 1 zone water timer

- Press the Pair/Watering button to start watering
- Press the Pair/Watering button again to stop watering.

### 2 zone water timer

- Press the irrigation button for the left port to start irrigation through the left port. Press the irrigation button for the right port to start irrigation through the right port.
- Press the irrigation button for the left port again to stop watering through the left port. Press the irrigation button for the right port again to stop watering through the right port.

## TROUBLESHOOTING & NOTES

### Troubleshooting

Problem	Solution
Weather Station Gateway Power problem	<ol style="list-style-type: none"><li>1. This weather station is designed to use a power adapter (5V) as the main power source and batteries are only used as a backup.</li><li>2. Replace the power adapter. It is important to use the correct adapter on all electronic equipment.</li></ol>
Outdoor sensor drains batteries quickly	<ul style="list-style-type: none"><li>* Check the distance and resistance between the outdoor sensor and the weather station. Outdoor sensors at the end of the range may work while batteries are fresh but not after they drain a bit.</li><li>* Check for leaking batteries, which may damage the outdoor sensor.</li><li>* Battery life is more than 12 months when using branded alkaline batteries.</li></ul>
Disconnection	<ul style="list-style-type: none"><li>* Connection problems are often resolved by changing batteries</li><li>* Distance/Resistance can cause loss of connection between the sensors/sub-devices and the weather station gateway.</li><li>* Rotate the weather station gateway 90 degrees toward the sensors/sub-devices for better reception. This allows more antenna surface to face the sensors/sub-devices signal.</li><li>* Try restarting the device and reconnecting.</li></ul>
Device offline	<ol style="list-style-type: none"><li>1. Check if the battery is fully charged or the power supply is normal.</li><li>2. Poor network signal or too far from the router.</li></ol>
The page displays the temperature value HH.H/LL.L	HH.H/LL.L is an indication when the temperature is higher/lower than the detection range.
Inaccurate Temperature/Humidity Reading	When the indoor temperature/humidity is inaccurate, it is often due to the location of the display or overpowered/underpowered batteries.

### NOTES:

- Please make sure you use a 2.4GHz WiFi band to connect to this product
- To operate smoothly and correctly, please place the weather station gateway on a stable plane for use.
- Do not mix old and new batteries or different types of batteries.
- Do not block the vent, insert fingers or any objects, as this may cause equipment failure or other conditions.
- Do not use the product near gas, heaters, microwave ovens and other positions that may cause interference.
- Do not wipe the screen with corrosive reagents which may affect the screen display.

## WARRANTY & SERVICE

The regular warranty period is 2 years and starts on the day of purchase. To benefit from an extended voluntary guarantee period as stated on the gift box, registration on our website is required. You can consult the full guarantee terms as well as information on extending the guarantee period and details of our services at [www.bresser.de/warranty\\_terms](http://www.bresser.de/warranty_terms).

## DISPOSAL



Dispose of the packaging materials by type. Observe the current legal regulations when disposing of the device! Information on proper disposal can be obtained from municipal waste disposal service providers or the Environmental Agency.



Do not dispose of electronic devices in the household waste! According to the European Directive 2012/19/EU on Waste Electrical and Electronic Equipment and its transposition into national law, used electrical equipment must be collected separately and recycled in an environmentally sound manner.

## DECLARATION OF CONFORMITY

### EC declaration of conformity



Hereby, Bresser GmbH declares that the equipment type with part number: 7510100 and 7510200 are in compliance with Directive: 2014/53/EU. The full text of the EU declaration of conformity is available at the following internet address:  
[www.bresser.de/download/7510100/CE/7510100\\_CE.pdf](http://www.bresser.de/download/7510100/CE/7510100_CE.pdf)

[www.bresser.de/download/7510200/CE/7510200\\_CE.pdf](http://www.bresser.de/download/7510200/CE/7510200_CE.pdf)

[www.bresser.de/download/7910100/CE/7910100\\_CE.pdf](http://www.bresser.de/download/7910100/CE/7910100_CE.pdf)

[www.bresser.de/download/7910101/CE/7910101\\_CE.pdf](http://www.bresser.de/download/7910101/CE/7910101_CE.pdf)

[www.bresser.de/download/7910102/CE/7910102\\_CE.pdf](http://www.bresser.de/download/7910102/CE/7910102_CE.pdf)

[www.bresser.de/download/7910103/CE/7910103\\_CE.pdf](http://www.bresser.de/download/7910103/CE/7910103_CE.pdf)

[www.bresser.de/download/7910104/CE/7910104\\_CE.pdf](http://www.bresser.de/download/7910104/CE/7910104_CE.pdf)

## SPECIFICATIONS

### Wireless specifications c

- Transmission distance of RF signal (in open air):  
Outdoor/Indoor Sensor/Smart Clock: up to 330 feet (100m).  
Water Timer/Soil Sensor: up to 196 feet (60m).
- Update Rate: Outdoor / Indoor Sensor: 2 minutes  
Water timer: Real time soil sensor: 8 minutes.
- Radio signal frequency 433.92 MHz
- WiFi band: 2.4 GHz only.

\*Obstacles such as walls, trees, and hills can cause significant signal loss.

\*Water in the air (moisture) can adversely affect RF signal strength.

### Measuring Specifications

Weather Station gateway/Outdoor Sensor/Indoor Sensor Specifications			
	Range	Accuracy	Disbandment
Indoor temperature	-9.9°C~50°C (14°F~122°F)	±1°C(±3.6°F)	0.1°C(0.2°F)
Outdoor temperature	-40°C~+60°C (-40°F~140°F)	±1°C(±3.6°F)	0.1°C(0.2°F)
Indoor humidity	1%RH~99%RH	±5%RH	1%
Outdoor humidity	1%RH~99%RH	±5%RH	1%
Barometric pressure	850~1050 hPa/mb (638~788 mmHg, 25.10~31.01 inHg)	±5 hPa/mb (±3.75 mmHg, ±0.148 inHg)	1hPa/mb(0.01 inHg,0.1mmHg)

**Note :** The data is relative humidity and pressure value.

Water Timer/Soil Sensor Specifications	
Measurement	Range
Working Water Pressure	0.5 bar to 8 bar (7.25-116.03PSI)
Work temperature	3°C-50°C (37°F-122°F)
Waterproof Level	IP54 (water timer) IPX5 (soil sensor)
Flow Rate	5L/min to 35L/min
Auto Watering	from 1 min to 60 min
Manual Watering	from 1 min to 11h59m

### power supply

- Weather station gateway: 5V DC adapter (included) or 3 x AA batteries (not included).
- Outdoor/Indoor Sensor: 2 x AA batteries (not included).
- Water Timer: 4 x AA batteries (not included).
- Soil Sensor/Smart Clock: 3 x AAA batteries (not included).

**NOTE:** Please use brand new high quality alkaline batteries for better performance. Do not mix old and new batteries. Heavy duty or rechargeable batteries are not recommended.



**EN AT CH BE**

Bei Fragen zum Produkt und eventuellen Reklamationen nehmen Sie bitte zunächst mit dem Service-Center Kontakt auf, vorzugsweise per E-Mail.

E-Mail: [service@bresser.de](mailto:service@bresser.de)  
Phone\*: +49 28 72 80 74 210

**Bresser GmbH**  
Kundenservice  
Gutenbergstr. 2  
46414 Rhede  
Deutschland

\*Local number in Germany (The amount of the charges per call depends on the tariff of your telephone provider); calls from abroad are associated with higher costs.

**EN IE**

Please contact the service centre first for any questions regarding the product or claims, preferably by e-mail.

E-Mail: [service@bresseruk.com](mailto:service@bresseruk.com)  
Telephone\*: +44 1342 837 098

**BRESSER UK Ltd.**  
Suite 3G, Eden House  
Enterprise Way  
Edenbridge, Kent TN8 6HF  
United Kingdom

\*Number charged at local rates in the UK (the amount you will be charged per phone call will depend on the tariff of your phone provider); calls from abroad will involve higher costs.

**FR BE**

Si vous avez des questions concernant ce produit ou en cas de réclamations, veuillez prendre contact avec notre centre de services (de préférence via e-mail).

E-Mail: [sav@bresser.fr](mailto:sav@bresser.fr)  
Téléphone\*: 00 800 6343 7000

**BRESSER France SARL**  
Pôle d'Activités de Nicopolis  
314 Avenue des Chênes Verts  
83170 Brignoles  
France

\*Prix d'un appel local depuis la France ou Belgique

**NL BE**

Als u met betrekking tot het product vragen of eventuele klachten heeft kunt u contact opnemen met het service centrum (bij voorkeur per e-mail).

E-Mail: [info@bresserbenelux.nl](mailto:info@bresserbenelux.nl)  
Telefoon\*: +31 528 23 24 76

**BRESSER Benelux**  
Smirnoffstraat 8  
7903 AX Hoogeveen  
The Netherlands

\*Het telefoonnummer wordt in het Nederland tegen lokaal tarief in rekening gebracht. Het bedrag dat u per gesprek in rekening gebracht zal worden, is afhankelijk van het tarief van uw telefoon provider; gesprekken vanuit het buitenland zullen hogere kosten met zich meebrengen.

**ES PT**

Si desea formular alguna pregunta sobre el producto o alguna eventual reclamación, le rogamos que se ponga en contacto con el centro de servicio técnico (de preferencia por e-mail).

E-Mail: [servicio.iberia@bresser-iberia.es](mailto:servicio.iberia@bresser-iberia.es)  
Teléfono\*: +34 91 67972 69

**BRESSER Iberia SLU**  
c/Valdemorillo,1 Nave B  
P.I. Ventorro del Cano  
28925 Alcorcón Madrid  
España

\*Número local de España (el importe de cada llamada telefónica dependen de las tarifas de los distribuidores); Las llamadas des del extranjero están ligadas a costes suplementarios..



**GARANTIE · WARRANTY · GARANTÍA · GARANZIA**



[www.bresser.de/warranty\\_terms](http://www.bresser.de/warranty_terms)

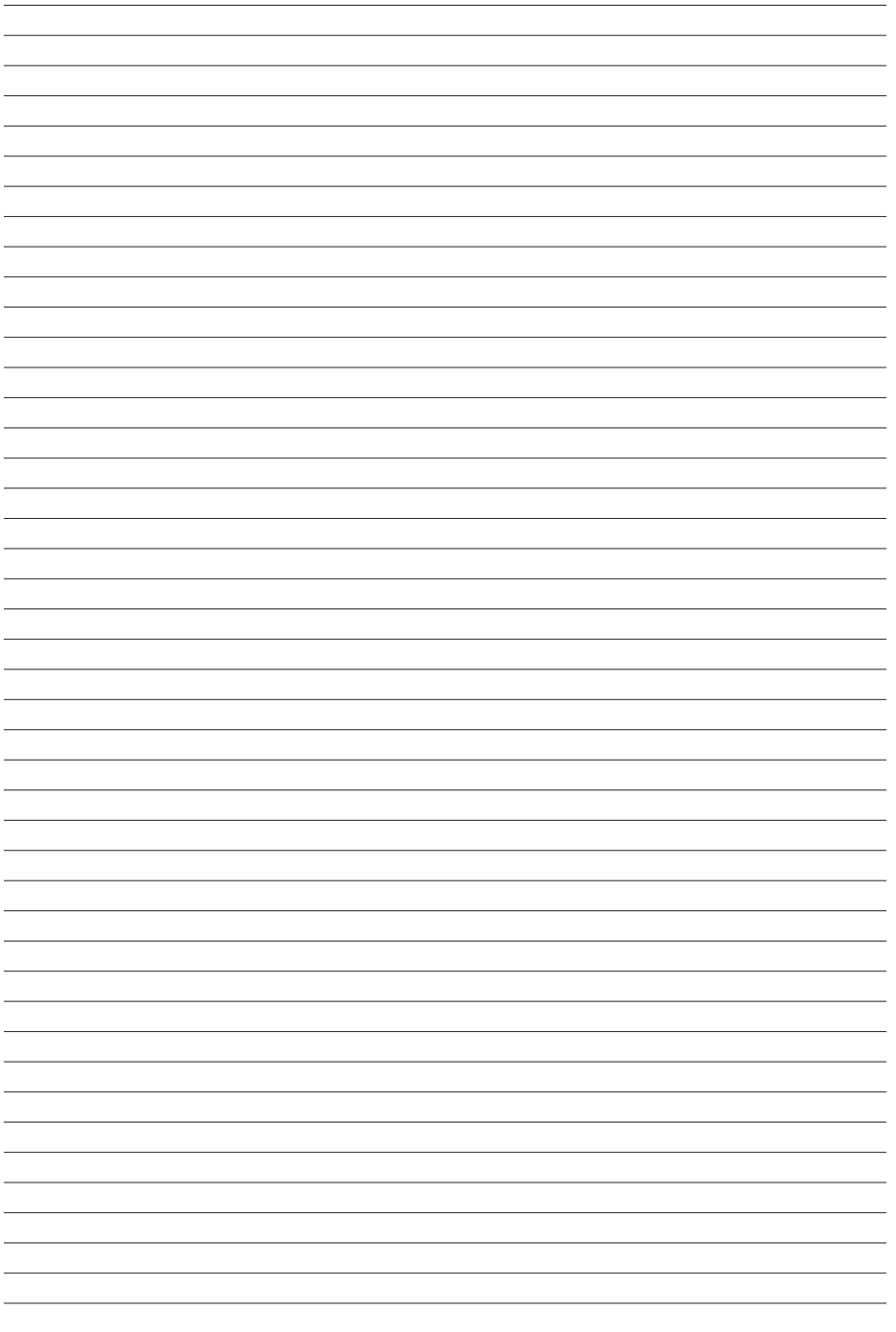

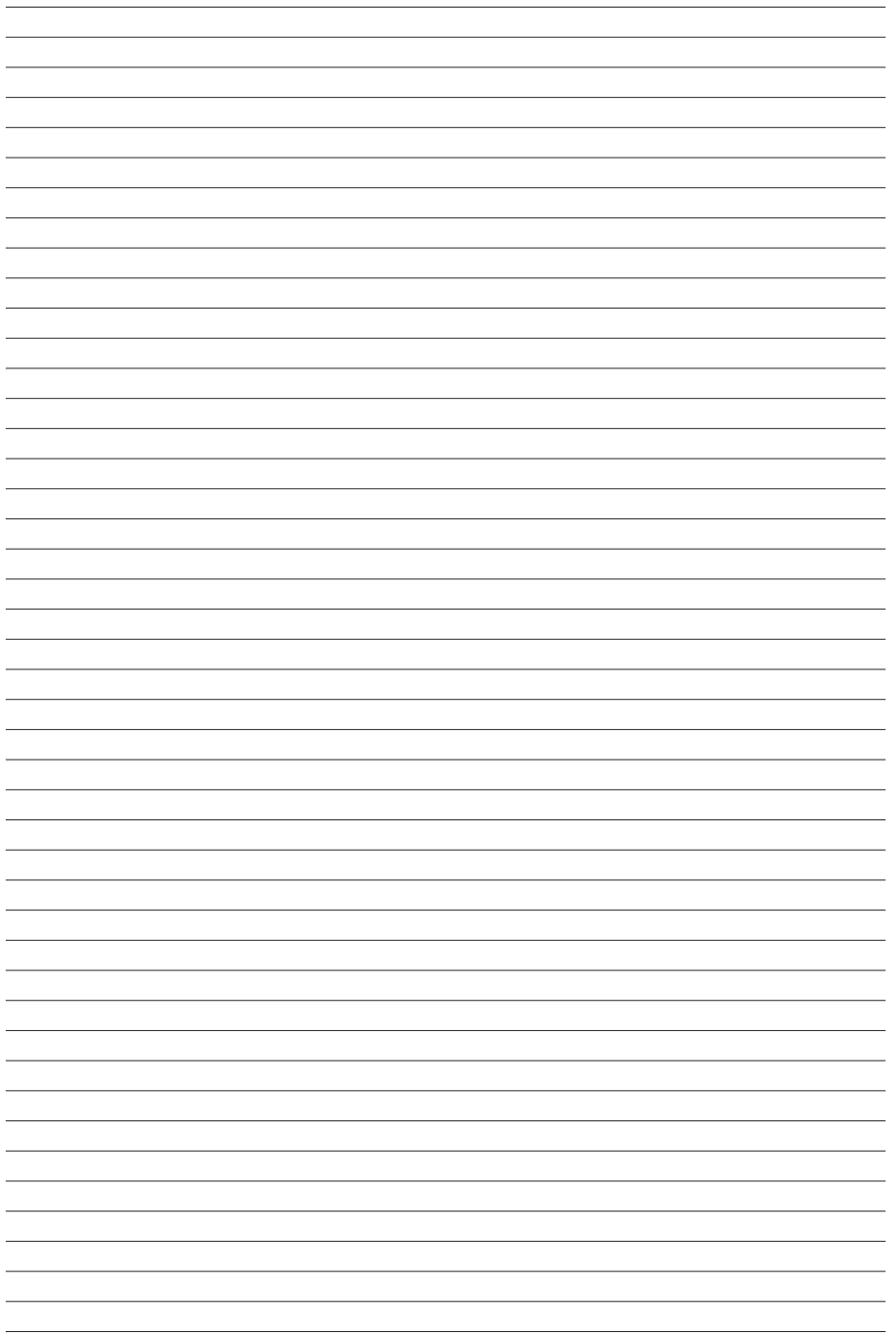

---

**Bresser GmbH**  
Gutenbergstr. 2  
46414 Rhede · Germany  
[www.bresser.de](http://www.bresser.de)

    @BresserEurope

**Bresser UK Ltd.**  
Suite 3G, Eden House  
Enterprise Way  
Edenbridge, Kent TN8 6HF  
Great Britain



Errors and technical changes reserved.

Manual\_7510100-7510200-7910100-7910101-7910102\_Gardening-Set\_en\_BRESSER\_v092023a